

# CABLE ASSEMBLY INSTRUCTIONS FOR TED 59 AND 69 CONNECTORS FOR SHIELDED CABLE.

## MIL-C-25516 FSCM 05209

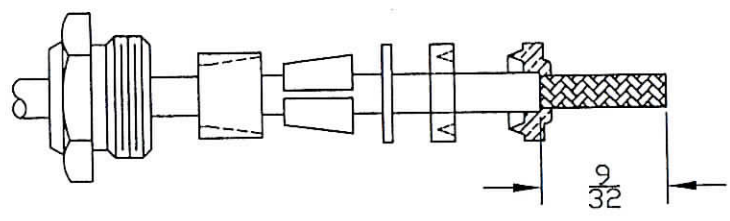

1. Cut cable off square and remove outer jacket to dimension shown. Slip cable nut, bushing, cable clamp, washer and gasket (v-groove as shown for 69 series - flat gasket on 59 series) over outer jacket of cable. Position braid clamp with inside shoulder against shoulder of outer jacket.

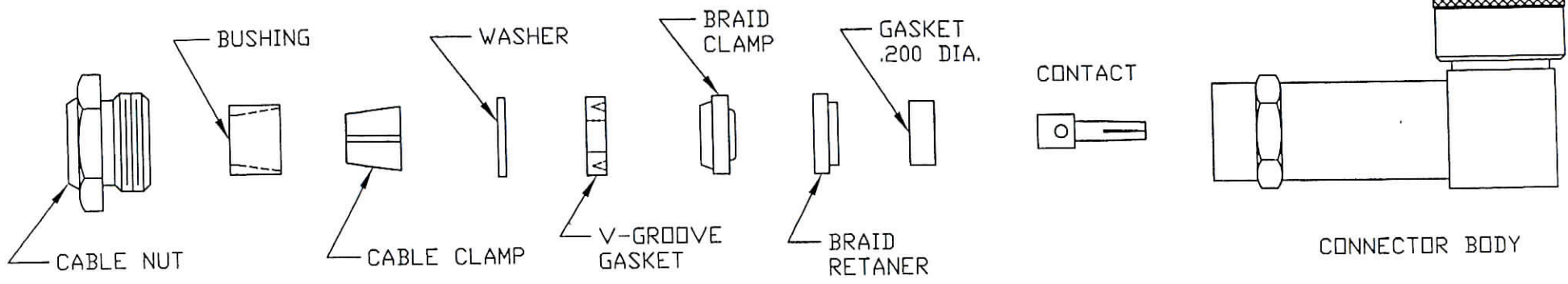
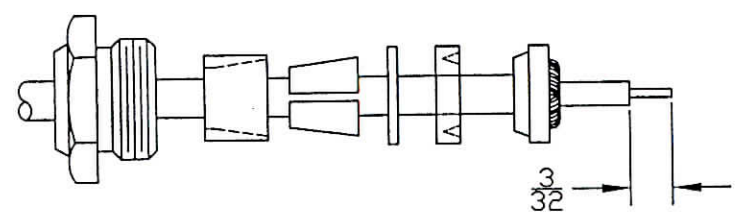

2. Comb out braid and fold back over braid clamp and trim off excess braid as shown. Trim dielectric from center conductor to dimension shown.

3. Position braid retainer and small gasket as shown. Push both tight against the braid clamp and solder contact to center conductor.

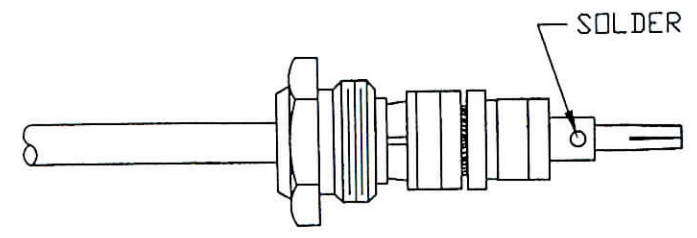

4. Insert assembly into connector body and tighten cable nut. Do not permit connector body or cable to rotate while tightening cable nut.