

REVISIONS

SYM.	DESCRIPTION	DATE	APPROVAL
B	ADDED TIGHTEN CABLE NUT TO 45-50 IN-LBS	1-21-14	SW

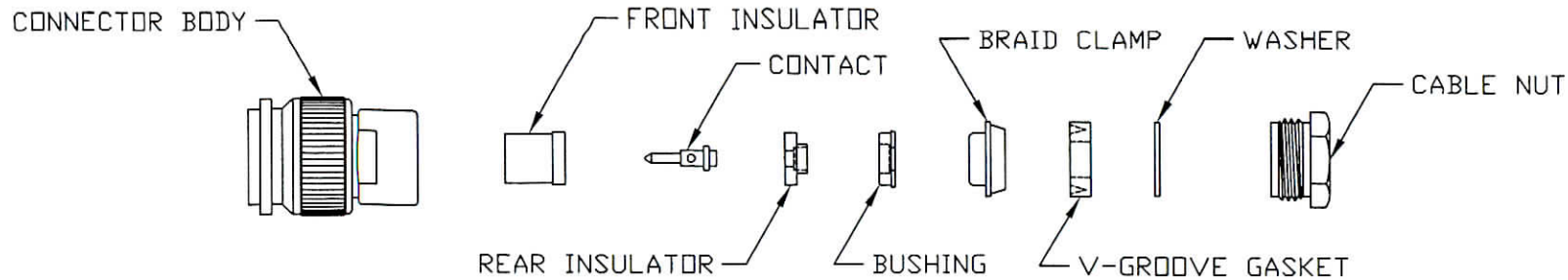

1. Layout and identify all parts as shown above. Slide cable nut, washer and V-groove gasket over cable as shown.

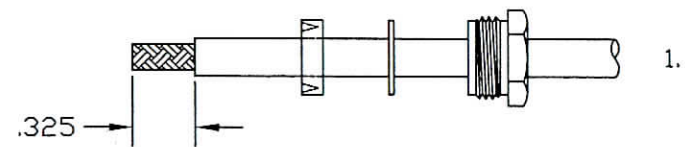

2. Slide braid clamp over braid until inner shoulder is tight against outer jacket. Fold braid over clamp and trim off excess even with large diameter of clamp. Trim center conductor to dimensions shown.

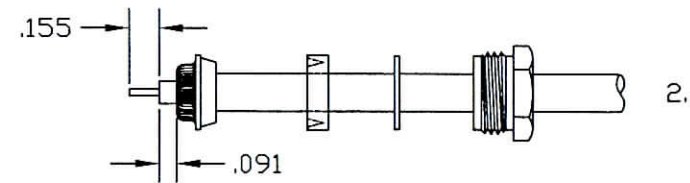

3. Slide bushing over dielectric. Position rear insulator making sure small diameter end is inserted into counter bore of bushing. Slip contact onto center conductor until shoulder of contact is tight against rear insulator. making sure all parts are tight, solder contact as shown.

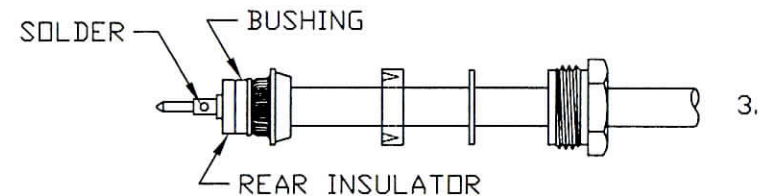

4. Position front insulator over contact as shown. Slide V-groove gasket, washer and cable nut forward as shown. Insert finished cable assembly into connector body and tighten Cable nut to 45 to 50in-lbs. (NOTE: Vee groove gasket must be split by braid clamp).

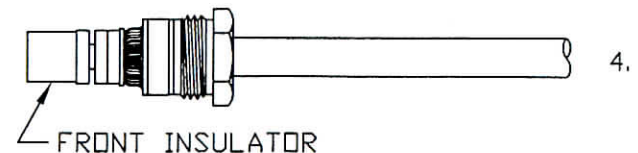

DR. WEISBACH	DATE 9-25-95
CK. <i>SW</i>	DATE 9-25-95
APPR. <i>SW</i>	DATE 9-25-95
APPR. <i>—</i>	DATE <i>—</i>

TITLE
CABLE ASSEMBLY
FOR 5-10-30

DWG. NO.
700152

REV.
B